



## High-Output BEC Setup and Installation Instructions

Covers Parts #2262

### CAUTION: RISK OF DAMAGE TO ELECTRONICS!

- Maximum input voltage = 12.6 volts (3s LiPo). Do not install on vehicles that accept higher voltage batteries.
- DO NOT install the BEC on vehicles with dual battery configurations. Incorrect installation of the wiring harness with 2-pin male connector can cause one of the batteries to short circuit, damage the BEC, damage the electronic speed control (ESC), and damage the batteries.
- This BEC accessory is not designed for use on vehicles equipped with dual steering servos.

#### Kit contents:

- Battery eliminator circuit (BEC)
- Receiver box cover
- Bind plug
• Wire clamp
- O-ring
- Foam pads (3)
- Y-harness
- 2.5x8mm CS (2)
- Silicone grease
- Zip tie (1)

#### Tools required:

- 2.0mm hex wrench
- Side cutters (to remove and trim zip ties)

#### BEC Installation:

1. Remove the three 3x8mm BCS from the existing receiver box cover; remove the cover.
2. Peel the backing from the "L" shaped foam pad and secure it the smooth surface portion on the bottom of the BEC.
3. Remove the backing from the other side of the foam pad and install the BEC onto the receiver as shown. Install the new o-ring seal on the receiver box. Ensure that the o-ring is properly seated in the groove.
4. Route the BEC power wire through the new receiver box cover.
5. Loosen the screws in the battery tray. Lift the battery tray and route the BEC power wire under the battery tray and over to the electronic speed control (ESC) (see *Wiring Diagram*).
6. Remove the existing zip tie, and then use the included zip tie to secure the wires to the transmission housing. **Note:** Ensure that no wires are pinched before retightening the screws in the battery tray.
7. Loosen the screws in the ESC and route the BEC power wire behind and under the ESC (see *Wiring Diagram*). Retighten the screws. Plug the red female connector from the BEC power wire into the red male connector from the ESC. **Note:** Use the supplied "Y" harness if another accessory is already plugged into the ESC.
8. Unplug the ESC connector from Channel 2 of the receiver; plug the connector into the BEC.
9. Plug the black connector from the BEC into Channel 2 of the receiver.
10. Install the remaining foam pads on the new receiver box cover and wire clamp. Apply a small bead of the supplied silicone grease to the foam pads.
11. Install the new receiver box cover using the 3x8mm BCS.
12. Place the BEC wire in the wire guide of the receiver box cover and install the wire clamp using the included 2.5x8 mm CS. Install the bind plug in the receiver box cover.

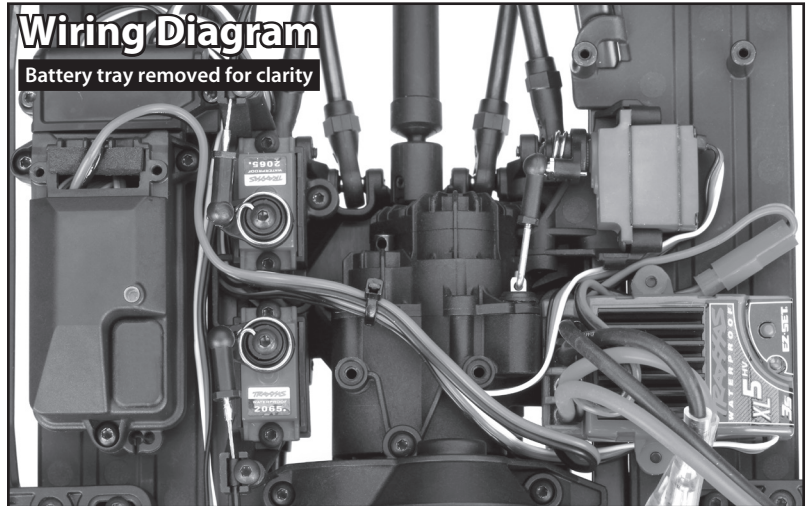
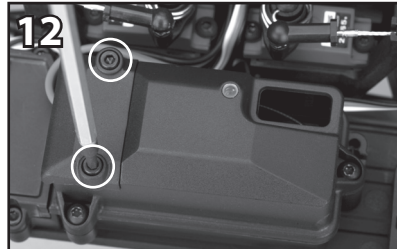
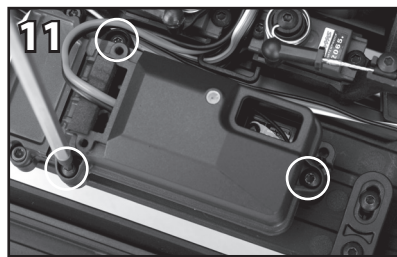
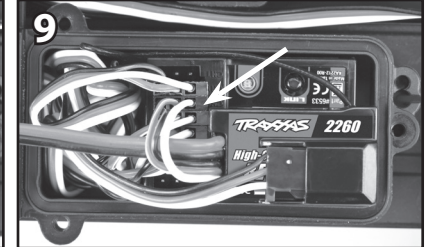
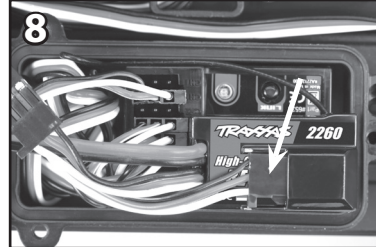
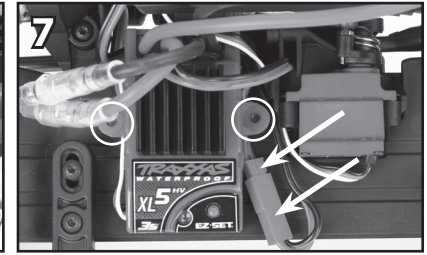
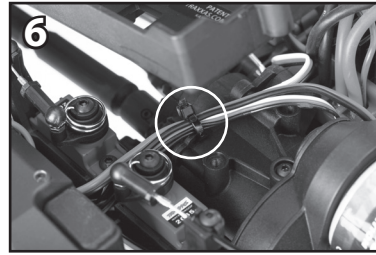
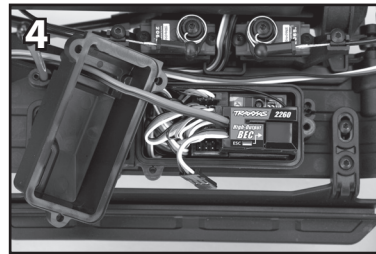
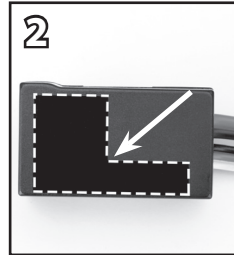
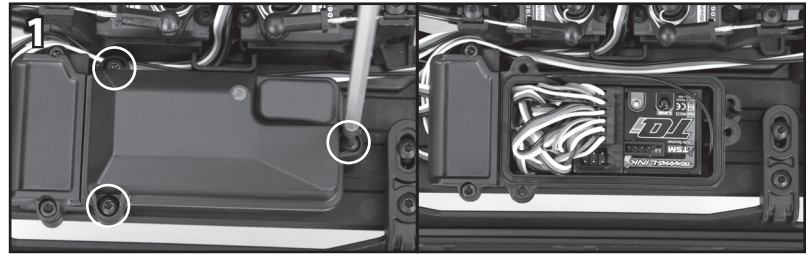

This device complies with FCC Part-15 & IC RSS-210 rules subject to the following conditions:  
1) This device may not cause harmful interference, and 2) This device must accept all interference received, including interference that may cause undesired operation.